

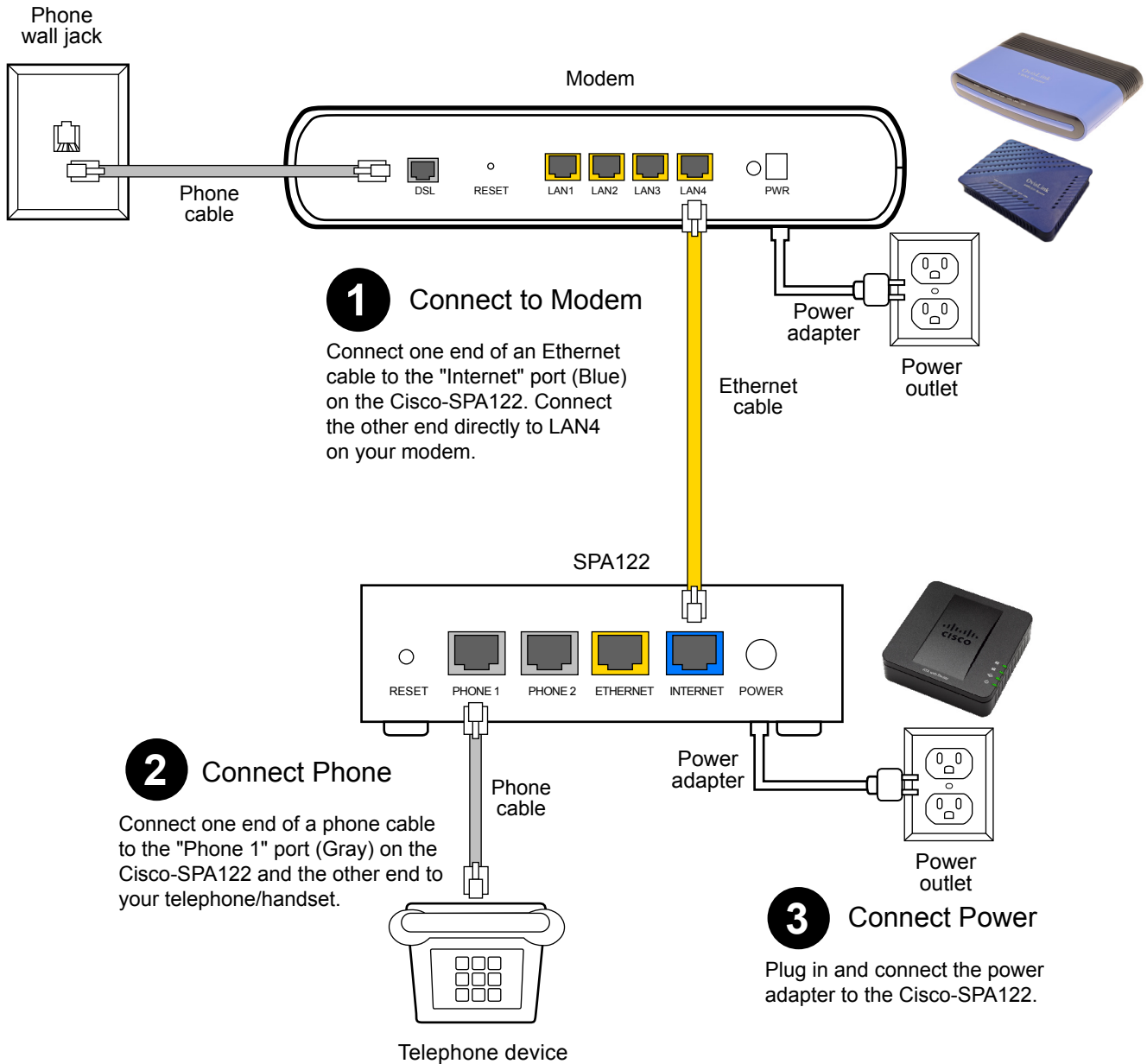

unⁱserve
constant | change

VoIP Set Up Guide



Troubleshooting - Lights:

System/Power:

- Steady green - System ready, IP address acquired.
- Slow flashing green - Acquiring IP address.
- Fast flashing green - Upgrading firmware.
- Off - No power or system can not boot up.

Internet:

- Flashing green - Transmitting or receiving data through the WAN port.
- Off - No link.

SPA Light Activity:

- Phone #1 & #2:
- Steady green - On hook.
- Slow flashing green - Off hook.
- Off - Port not ready.

Disclaimer

Actual devices may not look exactly as shown above. If you have problems identifying the devices, please contact us directly at 604.395.3900 or 1.844.395.3900.